

176056
331-3000

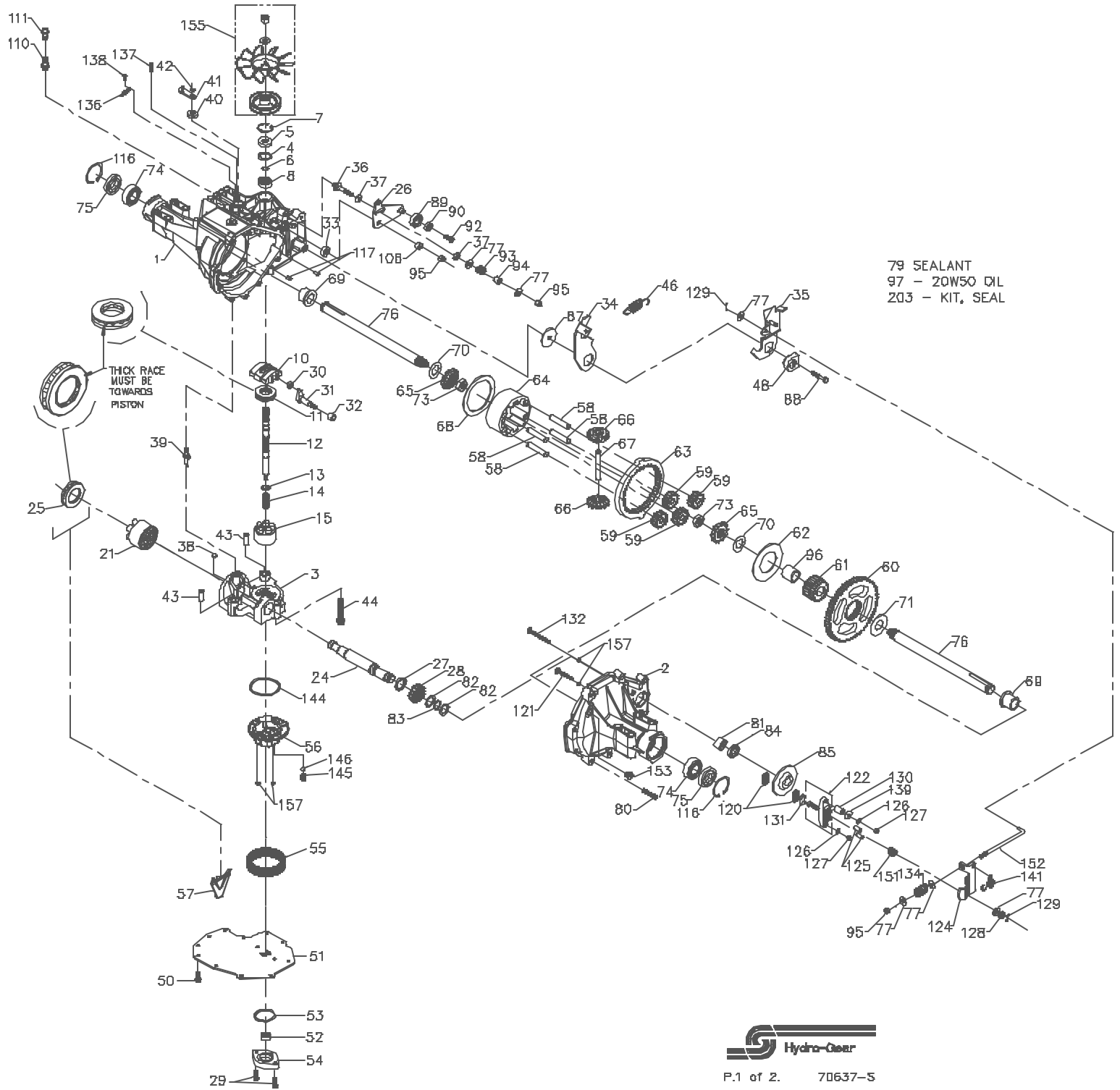

176056
331-3000

ITEM #	PART #	QTY	DESCRIPTION	ITEM #	PART #	QTY	DESCRIPTION	ITEM #	PART #	QTY	DESCRIPTION
1	70297	1	MAIN HOUSING ASSEMBLY	42	44870	1	RING, RETAINING	110	70110	1	FITTING, O-RING ASS'Y
		1	MAIN HOUSING	43	50002	2	PIN			1	FITTING, PLASTIC HOSE
		1	LIP SEAL	44	50016	3	SCREW 3/8-24 X 2.5			1	O-RING
		1	FLANGE BEARING	48	50833	1	SPRING, NEUTRAL	111	70108	1	VENT, CAP ASS'Y
		1	TRUNNION BUSHING	48	50835	1	PUCK, ADJUSTING			1	VENT, PLASTIC
		2	CRADLE BEARING	50	50752	11	SCREW, 1/4-20 X .75			1	VENT, CAP
2	70300	1	R.H. HOUSING ASSEMBLY	51	50972	1	COVER, LOWER	116	50859	2	RING, RETAINING
		1	R.H. HOUSING	52	50273	1	GEROTOR ASSEMBLY	117	8004800-2508	2	PIN, STD HDLS
		1	FLANGE BEARING	53	9004101-1340	1	O-RING	120	44132	2	PUCK, BRAKE
		2	O RING	54	50280	1	COVER, GEROTOR	121	50874	1	BOLT, RIB NECK 2"
		1	RIB NECK BOLT, 2"	55	70538	1	KIT, FILTER	122	70633	1	YOLKE, BRAKE ASSEMBLY
		1	RIB NECK BOLT, 3"	56	51156	1	MANIFOLD, CHARGE	124	50911	1	ARM, BRAKE
		1	NEEDLE BEARING (SCE1412)	57	50796	1	BEARING, MOTOR RETAINER	125	44127	2	PINS, BRAKE
		1	LIP SEAL (.875I.D.x1.30.D.x.25)	58	50776	4	PIN, CARRIER	126	43177	2	LOCKWASHER, 1/4"
3	70438	1	KIT, CENTER SECTION	59	50763	4	GEAR, 15T PLANET	127	43178	2	NUT, 1/4-20
		1	CENTER SECTION	60	50646	1	GEAR, 67T SPUR	128	44142	1	NUT, CASTLE 5/16-24
		1	DU BUSHING	61	50645	1	GEAR, 21 TOOTH SUN	129	44101	2	PIN, COTTER
		1	BUSHING	62	50769	1	PLATE, PLANET THRUST	130	23711	1	SPACER
		1	NO BLEED CHECK PLUG ASSEMBLY	63	50764	1	GEAR, 51T RING	131	44134	1	PUCK, PLATE
		1	.044 BLEED CHECK PLUG ASSEMBLY	64	50785	1	CARRIER, PLANETARY	132	50865	1	BOLT, RIB NECK 3"
		1	SPACER	65	50847	2	GEAR, MITER DIFF. (SPLINED)	134	50915	1	SPRING, BRAKE
4	2003018	1	LIP, SEAL 15 X 35 X 7	66	50848	2	GEAR, MITER DIFF.	136	50384	1	SPRING, EXTENSION
5	9008000-0128	1	RING, WIRE RETAINING	67	50786	1	SHAFT, DIFFERENTIAL	137	50882	1	PIN, SPRING
6	2003016	1	RING, RETAINING	68	50787	1	PLATE, DIFF. THRUST	138	50853	1	BOLT, SELF TAPPING 10-32 X .5
7	2003052	1	BEARING, BALL .59 X 1.38 X .43	69	50788	2	WASHER 1.075 X 1.750 X .038	139	44278	1	WASHER, 7/80D X .265ID X .125 THK
8	2003043	1	SWASHPLATE, VARIABLE	70	50770	2	WASHER 1.075 X 2.250 X .038	141	50884	1	SPRING, BRAKE ARM BIAS
10	2003087	1	BEARING, THRUST 30 X 52 X 13	71	50788	1	NUT, HEX JAM 5/8-18	152	50914	1	BRAKE PULL ROD
11	50551	1	BEARING, THRUST 30 X 52 X 13	73	50781	2	BEARING, BALL 82D5-1	153	9005110-5600	1	PLUG, STRAIGHT THREAD
12	50795	1	SHAFT, INPUT	74	50771	2	SEAL 1"ID X 2.0472" X .375"	155	70460	1	KIT, FAN/PULLEY
13	2003017	1	WASHER, THRUST .591X.787X.040	75	50772	2	SHAFT, AXLE			1	NUT, JAM 1/2-20
14	2003014	1	SPRING, BLOCK	76	50663	2	WASHER .343 X .880 X .062			1	WASHER, .531X1.25X.092 (BELLEVILLE)
15	70331	1	10cc CYLINDER BLOCK ASSEMBLY	77	44130	6	SEALANT			1	PULLEY
		1	10cc CYLINDER BLOCK	79	50928	1	SCREW, TORX HEAD 5/16-18			1	FAN
		5	10cc PISTON	80	50868	9	BEARING, NEEDLE (SCE1412)			4	O-RING, .070 X .239
		5	10cc PISTON SPRING	81	44752	1	WASHER .885 X 1.250 X .038	157	50877	1	KIT, SEAL
		5	PISTON SEAT WASHER	82	50777	2	RING, RETAINING	203	70492	1	
21	70082	1	21cc CYLINDER BLOCK ASSEMBLY	83	50775	1	SEAL, LIP .875I.D.x1.30.D.x.25				
		1	21cc CYLINDER BLOCK	84	50773	1	DISK, BRAKE				
		7	PISTON SEAT WASHER	85	50779	1	WASHER .324 X 1.960 X .146				
		7	21cc PISTON	87	50836	1	SCREW, 5/16-24 X 1-1/2				
		7	21cc PISTON SPRING	88	50837	1	BEARING				
24	50662	1	SHAFT, MOTOR	89	44147	1	SPACER, LOCATING				
25	50552	1	BEARING, THRUST 42 X 68 X 16	90	50839	1	SCREW, COUNTERSUNK 5/16-18				
26	50857	1	ARM, CONTROL	92	50870	1	SPRING				
27	50774	1	SPACER	93	50277	1	SPACER				
28	50661	1	GEAR, 16T PINION	94	50278	1	NUT, HEX LOCK 5/16-24				
29	50975	2	CAPSCREW, M6 X 1-25	95	50108	3	BEARING, SLEEVE				
30	2000015	1	SLOT GUIDE	96	50886	1	20W-50 OIL				
31	50807	1	ARM, TRUNNION TAPERED SQUARE	106	50850	1	SPACER, TRUNNION				
32	2003008	1	BUSHING, TRUNNION	108	9005200-5600	1	PLUG, PLASTIC				
33	8008000-0126	1	SEAL, LIP 12 X 25 X 7								
34	50831	1	ARM, RETURN								
35	50832	1	ARM, ACTUATING								
36	50284	1	STUD, 5/16-24								
37	50281	2	PUCK, FRICTION								
38	2003654	1	PLATE, BYPASS								
39	2003655	1	ACTUATOR, BYPASS								
40	45074	1	SEAL, LIP 10 X 25 X 7								
41	50270	1	ARM, BYPASS								