

K121111121  
323-3000

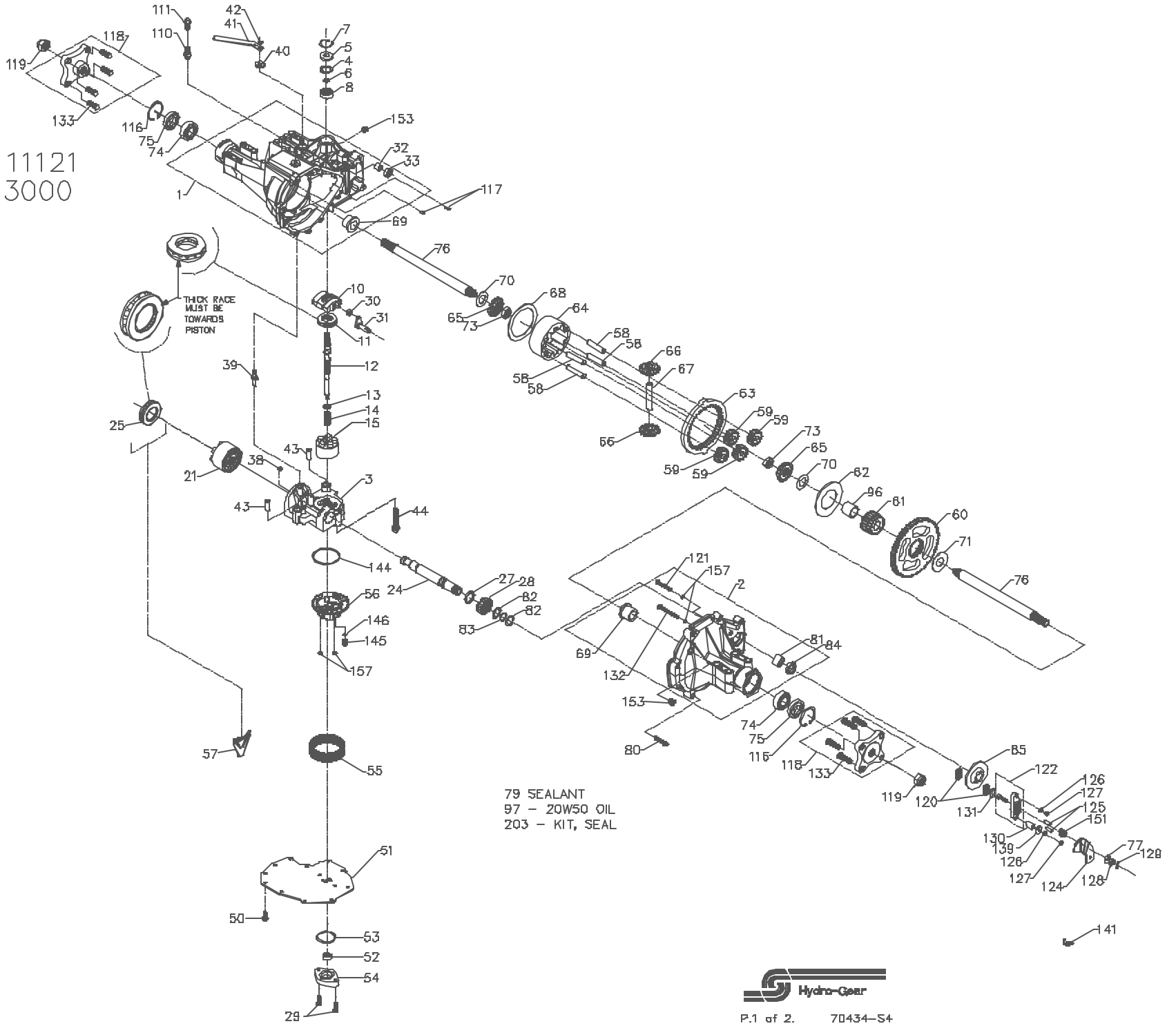

K121111121  
323-3000

ITEM #	PART #	QTY	DESCRIPTION	ITEM #	PART #	QTY	DESCRIPTION
1	70433	1	HOUSING, MAIN ASSEMBLY	130	23711	1	SPACER
		1	HOUSING, MAIN	131	44134	1	PUCK, PLATE
		2	BEARING, GRADLE	132	50865	1	BOLT, 3" RIB NECK
		1	BUSHING, TRUNNION	133	50868	8	STUD, WHEEL
		1	SEAL, LIP 12X25X7	139	44278	1	WASHER .875X.265X.125
2	70298	1	BEARING, FLANGE	141	50884	1	SPRING, BRAKE ARM BIAS
		1	HOUSING, R.H. ASSEMBLY	144	50974	1	O-RING .103X2.987
		1	HOUSING, R.H.	145	51157	1	SPRING, RELIEF
		1	BEARING, FLANGE	146	9001214-4400	1	BALL 7/16
		2	O-RING .070X.239	151	50919	1	SPRING, COMP. BRAKE ANTI-DRAW
		1	BOLT, 2" RIB NECK	153	9005110-5600	2	PLUG, STRAIGHT THREAD
		1	BOLT, 3" RIB NECK	157	50977	4	O-RING .070X.239
		1	BEARING, NEEDLE .875X1.125X.75D	203	70492	1	KIT, SEAL
		1	SEAL, LIP .875X1.375X.250			1	SEAL, LIP 15X35X7
3	70437	1	KIT, CENTER SECTION			1	SEAL, LIP 12X25X7
		1	CENTER SECTION			1	SEAL, LIP 10X25X7
		1	BUSHING .50X.595X.50			2	O-RING .103X1.862
		1	BUSHING .80X1.02X.75			1	O-RING .103X1.862
		2	CHECK PLUG ASSEMBLY, .027			2	SEAL, LIP 1.000X2.049X.375
4	2003018	1	SPACER			1	SEAL, LIP .875X1.375X.250
5	9008000-0128	1	SEAL, LIP 15X35X7			2	O-RING .070X.239
6	2003016	1	RING, WIRE RETAINING			1	KIT, O-RING, MANIFOLD
7	2003052	1	RING, RETAINING				
8	2003043	1	BEARING, BALL 15X35X11	56	51156	1	MANIFOLD, CHARGE
10	2003087	1	SWASHPLATE, VARIABLE	57	50796	1	RETAINER, MOTOR BEARING
11	50551	1	BEARING, THRUST 30X52X13	58	50778	4	PIN, CARRIER
12	50795	1	SHAFT, INPUT	59	50783	4	GEAR, 15T PLANET
13	2003017	1	WASHER, BLOCK THRUST	60	50646	1	GEAR, 67T SPUR
14	2003014	1	SPRING, BLOCK	61	50645	1	GEAR, 21 TOOTH SUN
15	70331	1	BLOCK, 10cc CYLINDER ASSEMBLY	62	50789	1	PLATE, PLANET THRUST
		1	BLOCK, 10cc CYLINDER	63	50784	1	GEAR, 51T RING
		5	PISTON, 10cc	64	50785	1	CARRIER, PLANETARY
		5	SPRING, 10cc PISTON	65	50647	2	GEAR, MITER DIFF. (SPLINED)
		5	WASHER, PISTON SEAT	66	50648	2	GEAR, MITER DIFF.
21	70082	1	BLOCK, 21cc CYLINDER ASSEMBLY	67	50766	1	SHAFT, DIFFERENTIAL
		1	BLOCK, 21cc CYLINDER	68	50787	1	PLATE, DIFF. THRUST
		7	WASHER, PISTON SEAT	69	50788	2	BEARING, FLANGE
		7	PISTON, 21cc	70	50770	2	WASHER 1.0X1.75X.04
		7	SPRING, 21cc PISTON	71	50788	1	WASHER 1.0X2.25X.04
24	50662	1	SHAFT, MOTOR	73	50791	2	NUT, HEX JAM 5/8-18
25	50552	1	BEARING, THRUST 42X68X16	74	50771	2	BEARING, BALL 25.4X52X15
27	50774	1	SPACER	75	50772	2	SEAL 1.000X2.049X.375
28	50661	1	GEAR, 16T PINION	76	50825	2	SHAFT, AXLE
29	50975	2	CAPSCREW M6X1-25	77	44130	1	WASHER .34X.88X.06
30	2000015	1	GUIDE, SLOT	79	50928	1	SEALANT
31	2003005	1	ARM, TRUNNION	80	50868	9	SCREW, TORX HEAD 5/16-18
32	2003009	1	BUSHING, TRUNNION	81	44752	1	BEARING, NEEDLE .875X1.125X.750
33	9008000-0126	1	SEAL, LIP 12X25X7	82	50777	2	WASHER .88X1.24X.04
38	2003554	1	PLATE, BYPASS	83	50775	1	RING, RETAINING
39	2003555	1	ACTUATOR, BYPASS	84	50773	1	SEAL, LIP .875X1.30X.25
40	45074	1	SEAL, LIP 10X25X7	85	50779	1	DISK, BRAKE
41	50929	1	ARM, BYPASS	86	50866	1	BEARING, SLEEVE 1.0X1.31X1.34
42	44870	1	RING, RETAINING	87		122 OZ	OIL-20W50
43	50002	2	PIN	110	70110	1	FITTING, O-RING ASS'Y
44	50018	3	SCREW 3/8-24X2.5			1	FITTING, PLASTIC HOSE
				111	70109	1	O-RING
						1	VENT, CAP ASS'Y
						1	VENT, PLASTIC
						1	VENT, CAP
				116	50859	2	RING, RETAINING
				117	9004800-25D6	2	PIN, STD HDLS
				118	70314	2	HUB, ASSEMBLY
						1	HUB
				119	50863	4	BOLT, LUG 1/2-20
				120	44132	2	NUT, HEX 3/4-16
				121	50874	1	PUCK, BRAKE
				122	70633	1	BOLT, 2" RIB NECK
				124	50936	1	YOKE, BRAKE ASSEMBLY
				125	44127	2	ARM, BRAKE
				126	43177	2	PINS, BRAKE
				127	43178	2	LOCKWASHER 1/4"
				128	44142	2	NUT 1/4-20
						1	NUT, CASTLE
						1	PIN, COTTER